



intAct Bike-Power Classic

Low-maintenance lead-acid battery | dry-charged, acid pack included | low maintenance

Art.No.

52430S

Japancode

U1

Volt	12V
Capacity	24 Ah (c20)
CCR -18°C (EN)	220 A (EN)
Electrolyte	diluted sulphuric acid
Electrolyte density	1,28 +/- 0,01 kg/l (25°)
Size (LxWxH)	196 x 130 x 184 mm
Weight	8,2 kg
Pos. of Terminal	1
Terminal	4
Entgasung	6

Usage



Powerful and sustainable

The solid battery without frills delivers high starting power, with regular maintenance it achieves a long service life and has excellent recycling properties. Our recommendation for an inexpensive standard motorcycle battery.

- » **Reliable starting power at an excellent price.**
- » **Replacement recommendation** for broken flooded battery.
- » **Central degassing.**
- » **Only to be installed upright**, as flooded battery with vent caps.



Size

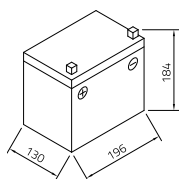

Pos. of Terminal 1

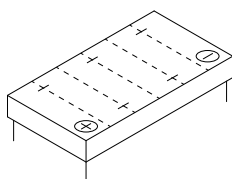

Terminal 4

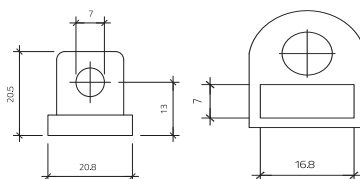

Entgasung 6

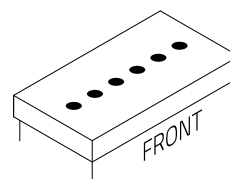

As of 28.01.2026