



# Intact Start-Power Asia

Closed calcium battery (Ca/Ca) | filled and charged | maintenance-free

Art.No.

## 53522GUG

Volt	12V
Capacity	35 Ah (c20)
CCR -18°C (EN)	300 A (EN)
Electrolyte	diluted sulphuric acid
Electrolyte density	1,28 +/- 0,01 Kg/l (25° C)
Size (LxWxH)	187 x 127 x 227 mm
Weight	9,8 kg
Pos. of Terminal	1
Terminal	3
Bodenleiste	-

### Usage



## Top performance at a great price

Developed for performance and extreme high-current capability at an absolutely perfect price-performance ratio. For almost all standard cars without many additional installations and other electrical consumers. Our recommendation for standard applications with low requirements and the best price-performance ratio.

- » **Powerful and reliable.**
- » **Double lid for increased leakage protection and gas condensation** (gaseous electrolyte condenses in the labyrinth lid and remains in the circuit).
- » **Filled and charged. Ready for immediate use.**
- » **Maintenance-free. No refilling of water necessary.**



### Size

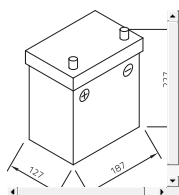

### Pos. of Terminal 1

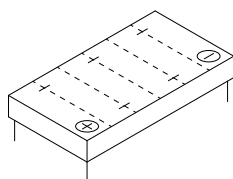

### Terminal 3

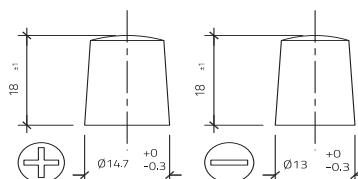

### Bodenleiste -

As of 26.01.2026