



intAct Start-Power

Calcium or hybrid battery (Ca/Ca or Sb/Ca)

Art.No.

58827GUG

Volt	12V
Capacity	90 Ah (c20)
CCR -18°C (EN)	720 A (EN)
Electrolyte	diluted sulphuric acid
Electrolyte density	1,28 +/- 0,01 Kg/l (25° C)
Size (LxWxH)	353 x 175 x 190 mm
Weight	20,4 kg
Pos. of Terminal	0
Terminal	1
Bodenleiste	B13

Usage



Top performance at a great price

Developed for performance and extreme high-current capability at an absolutely perfect price-performance ratio. For almost all standard cars without many additional installations and other electrical consumers. Our recommendation for standard applications with low requirements and the best price-performance ratio.

- » **Powerful and reliable.**
- » **Double lid for increased leakage protection and gas condensation** (gaseous electrolyte condenses in the labyrinth lid and remains in the circuit).
- » **Filled and charged. Ready for immediate use.**
- » **Maintenance-free. No refilling of water necessary.**



Size

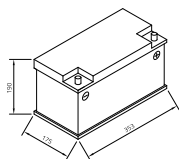

Pos. of Terminal 0

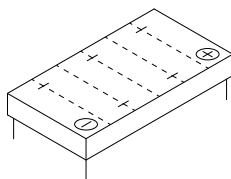

Terminal 1

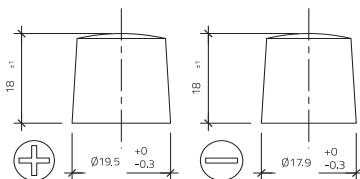

Bodenleiste B13

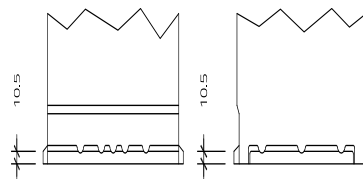

As of 18.07.2025